

TAILORED MORTGAGE ENGINEERING BY FIRM CAPITAL®

- Bridge Financing - 1st & 2nd Mortgages
- Land & Construction Financing
- Purpose Built Rental Construction
- Infill Construction
- Residential Mortgages
- Mezzanine Equity Capital
- Preferred Equity Capital
- Partnerships for Investment Properties
- Joint Venture Equity Capital

SELECTED TRANSACTIONS - BOUTIQUE MORTGAGE LENDERS®

REFINANCE

\$10,250,000

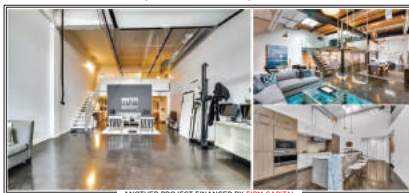

FIRST MORTGAGE

11 loft condominium units consisting of 3 live/work units and 8 commercial units
 📍 TORONTO, ON

INVENTORY LOAN

\$40,000,000



FIRST MORTGAGE

Two 11-storey residential condominium/apartment buildings comprising 262 units with a combined total of 225,768 net saleable/leasable sq. ft.
 📍 LONDON, ON

ACQUISITION LOAN

\$3,570,000

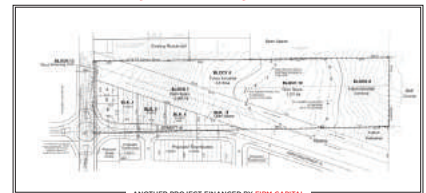

FIRST MORTGAGE

4.85 acres of developable area approved for 3 detached dwellings, 15 townhouse units and future industrial use
 📍 OSHAWA, ON

BRIDGE LOAN

\$6,000,000



FIRST MORTGAGE

20,000 sq. ft. site for the future development of a mixed-use building (collateral security included two 60,000 sq. ft. commercial properties)
 📍 MONTREAL, QC

REFINANCE

\$3,000,000



FIRST MORTGAGE

4,782 sq. ft. custom built single-family home
 📍 TORONTO, ON

LAND & CONSTRUCTION LOAN

\$1,500,000



FIRST MORTGAGE

Construction of a 4,331 sq. ft. custom home
 📍 GREELY, ON

RELATIONSHIP DRIVEN • EXECUTION FOCUSED

FOR MORE INFORMATION, PLEASE CONTACT:



REAL ESTATE CREDIT STRATEGIES

Firm Capital

📞 (416) 635-0221

✉️ mortgages@firmcapital.com

🌐 www.FirmCapital.com